



Univerzální montážní plán

Domek se sedlovou střechou

Zahradní domky
MICHAL ZELMAN

www.nezahradnidomek.cz

Základní rošt pro podlahu (vzorový – v závislosti na typu domku)

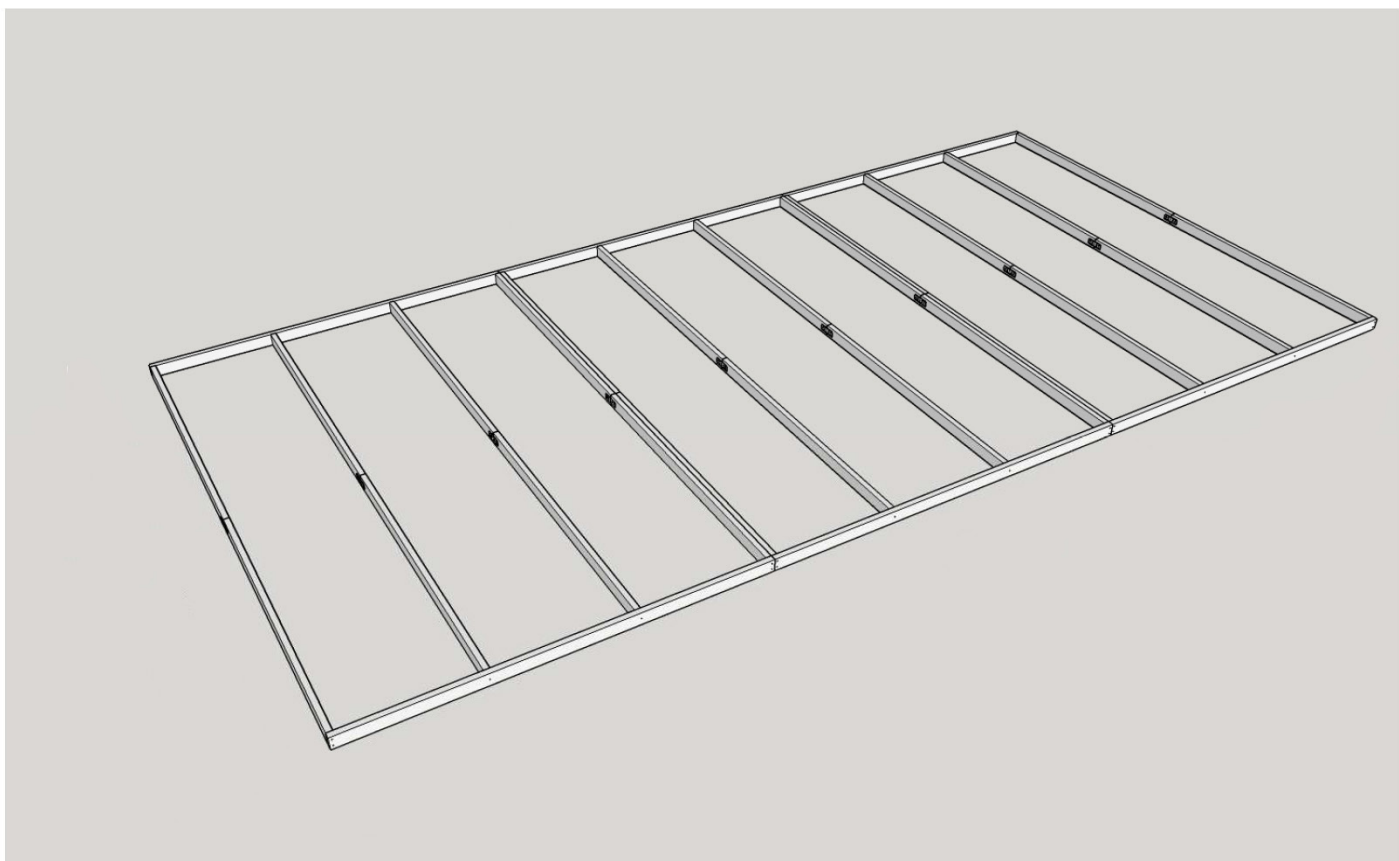
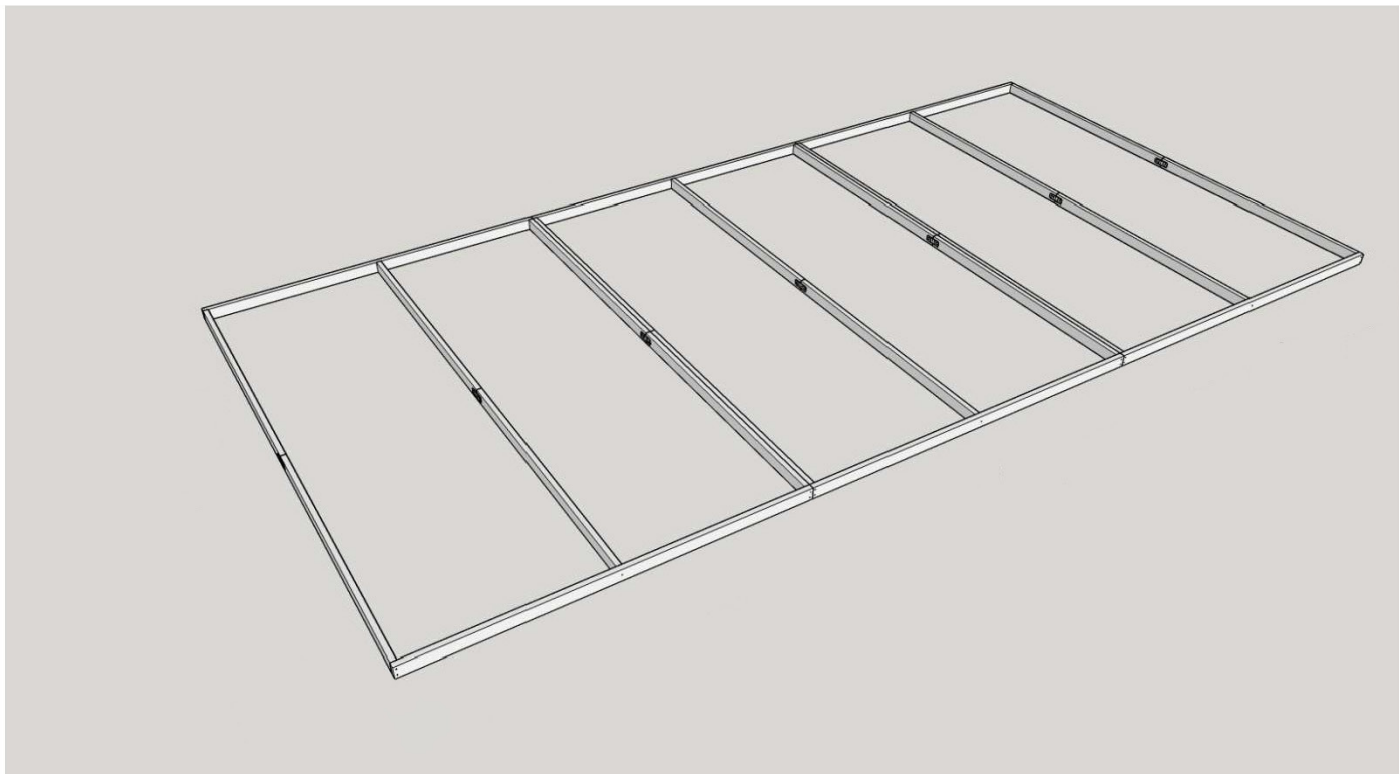

Kladení podlahy (vzorové – v závislosti na typu domku)

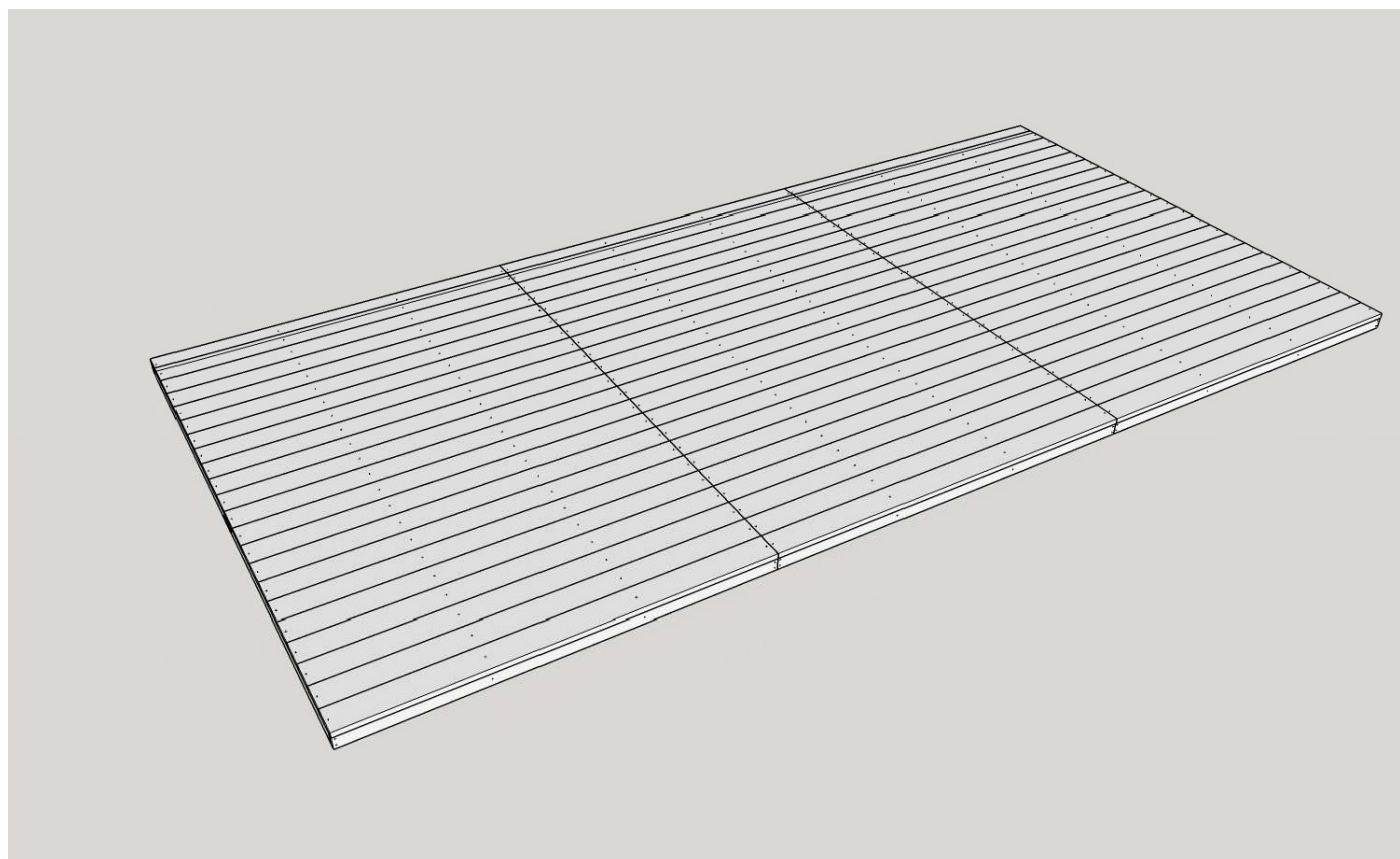
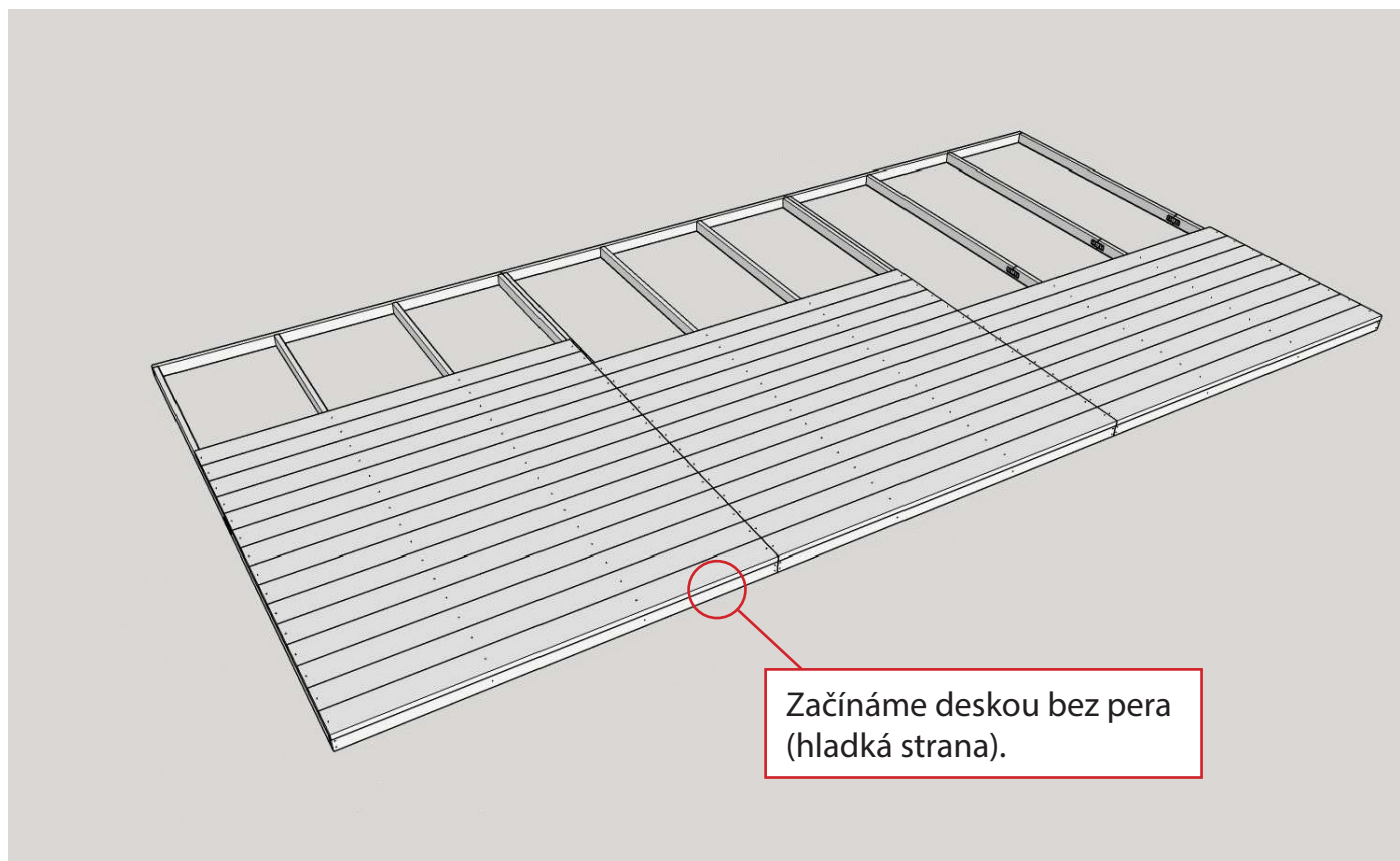

Uložení stěn domku

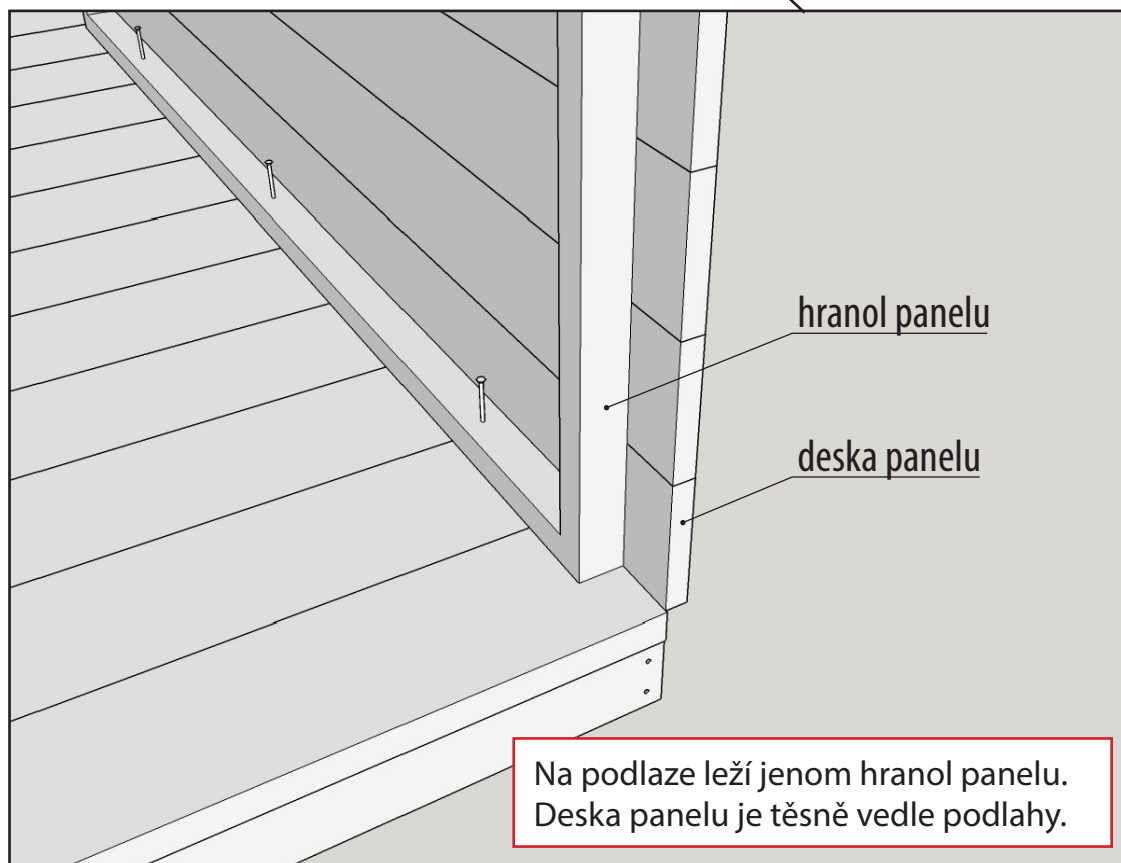
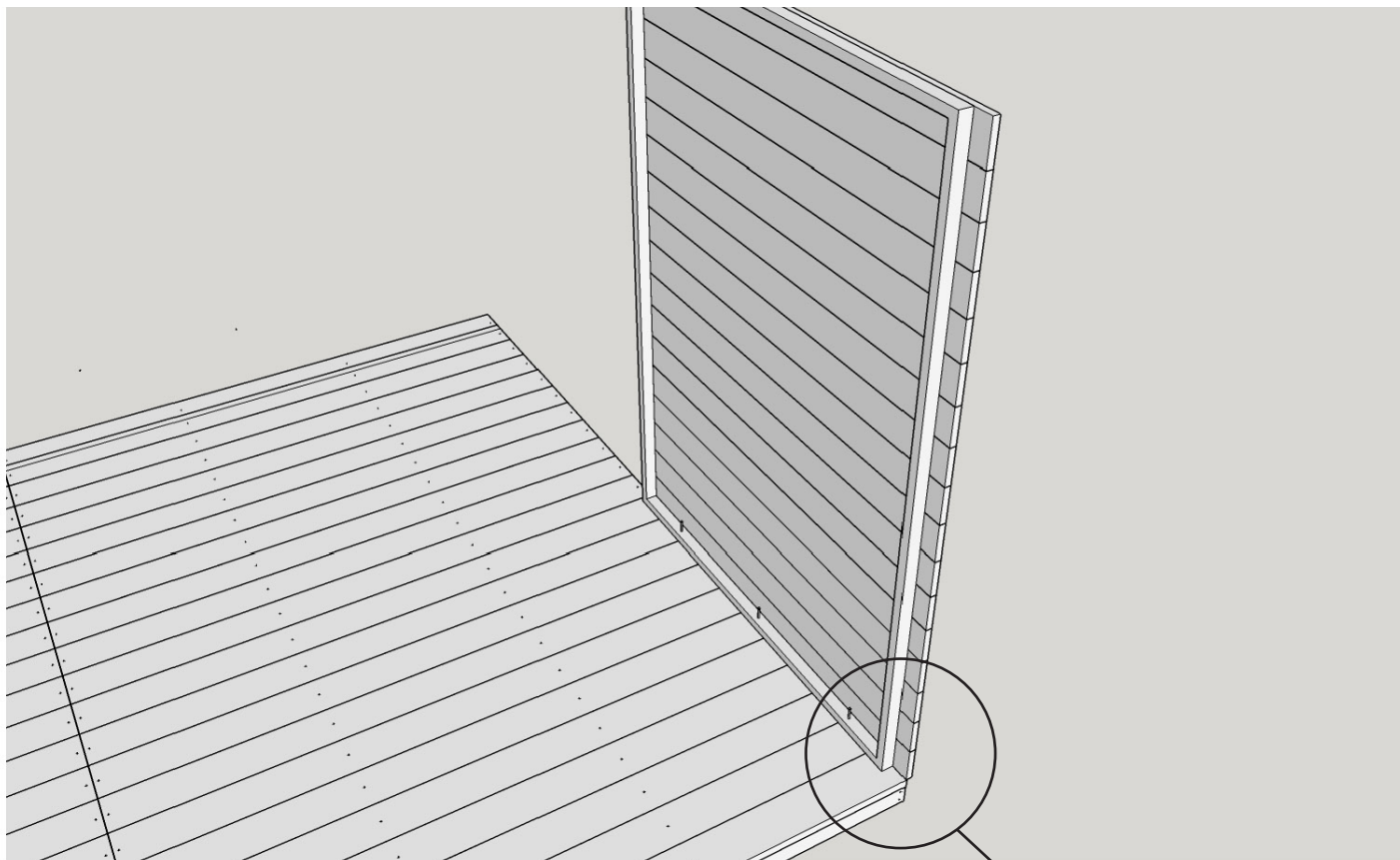

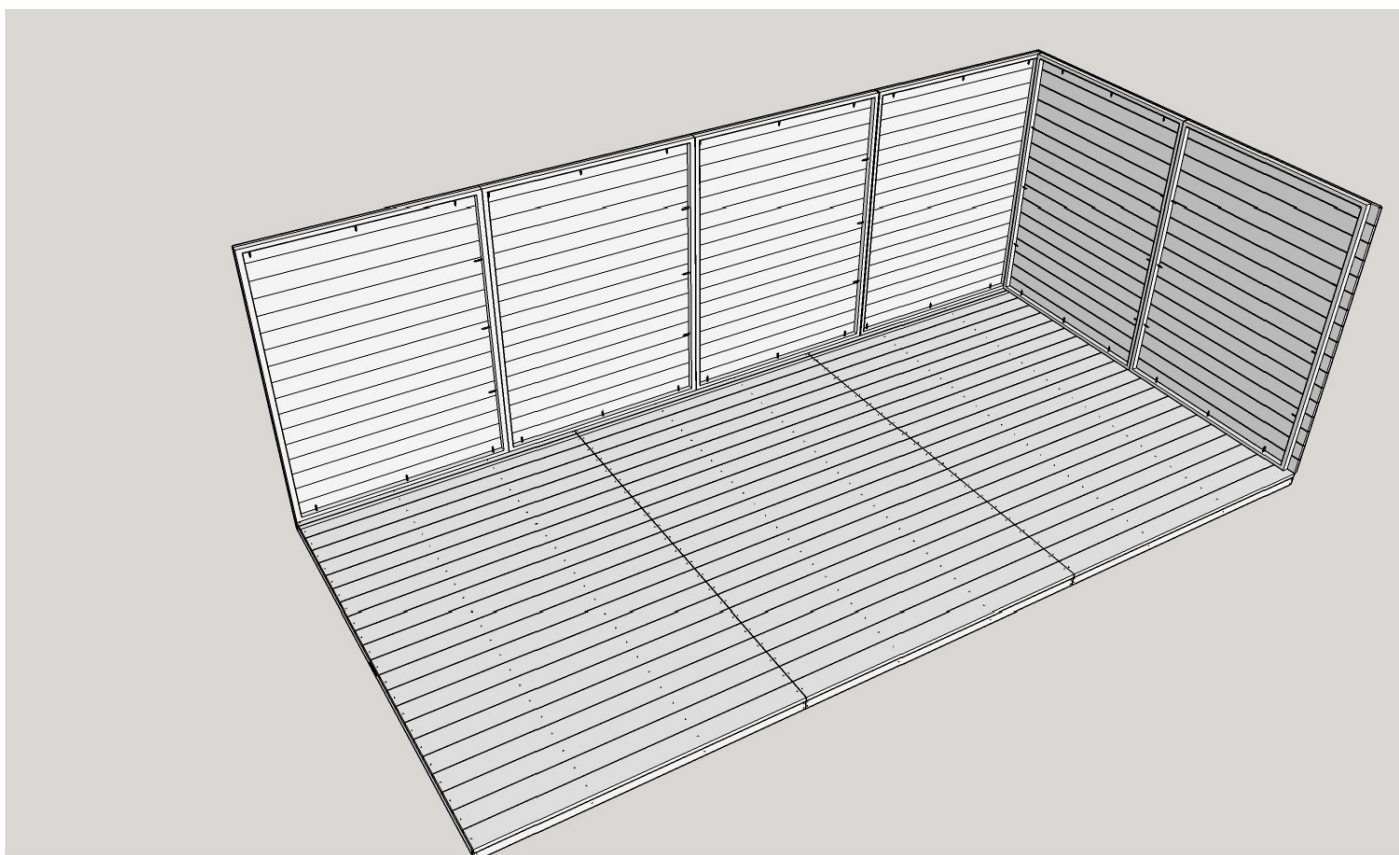
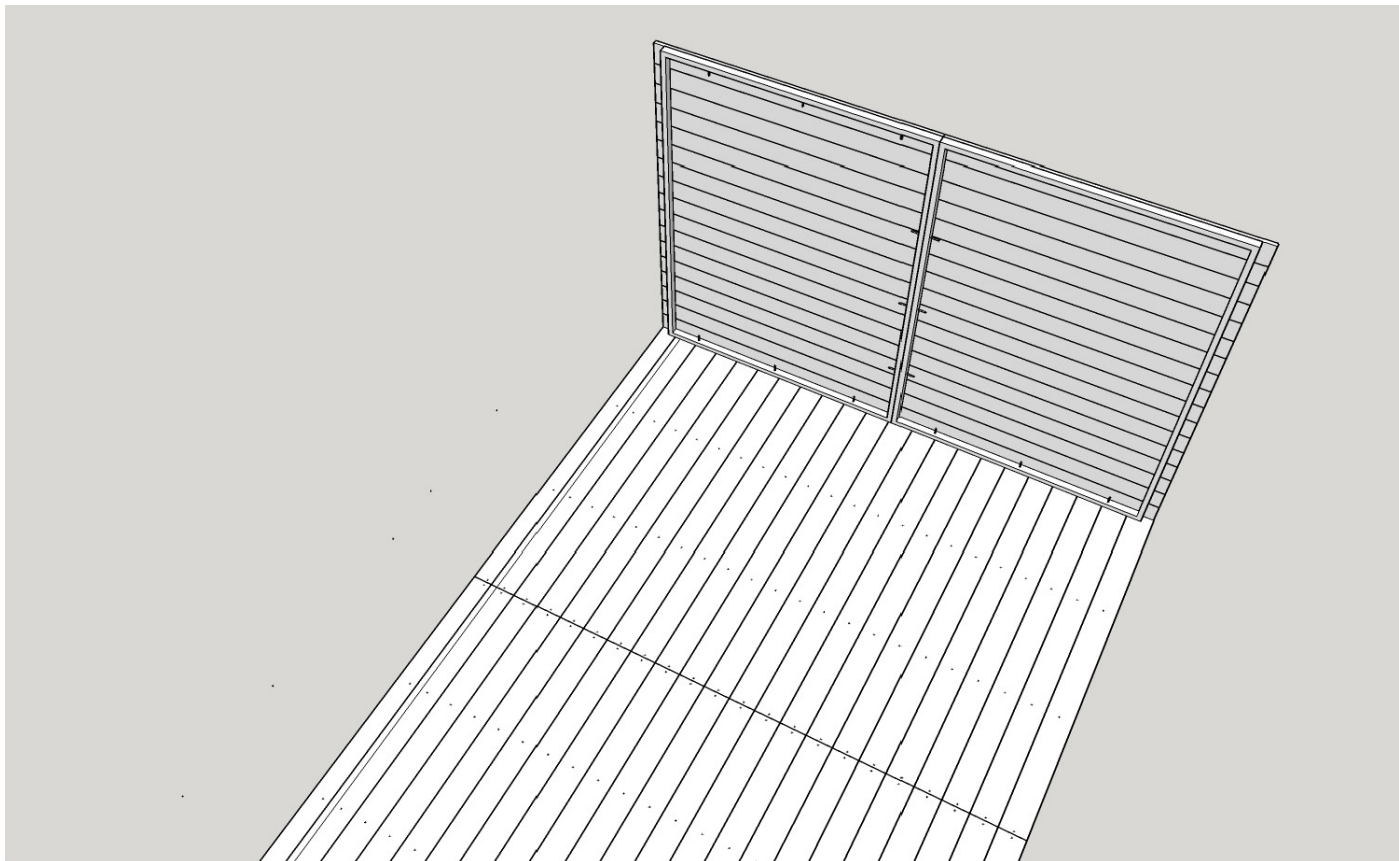

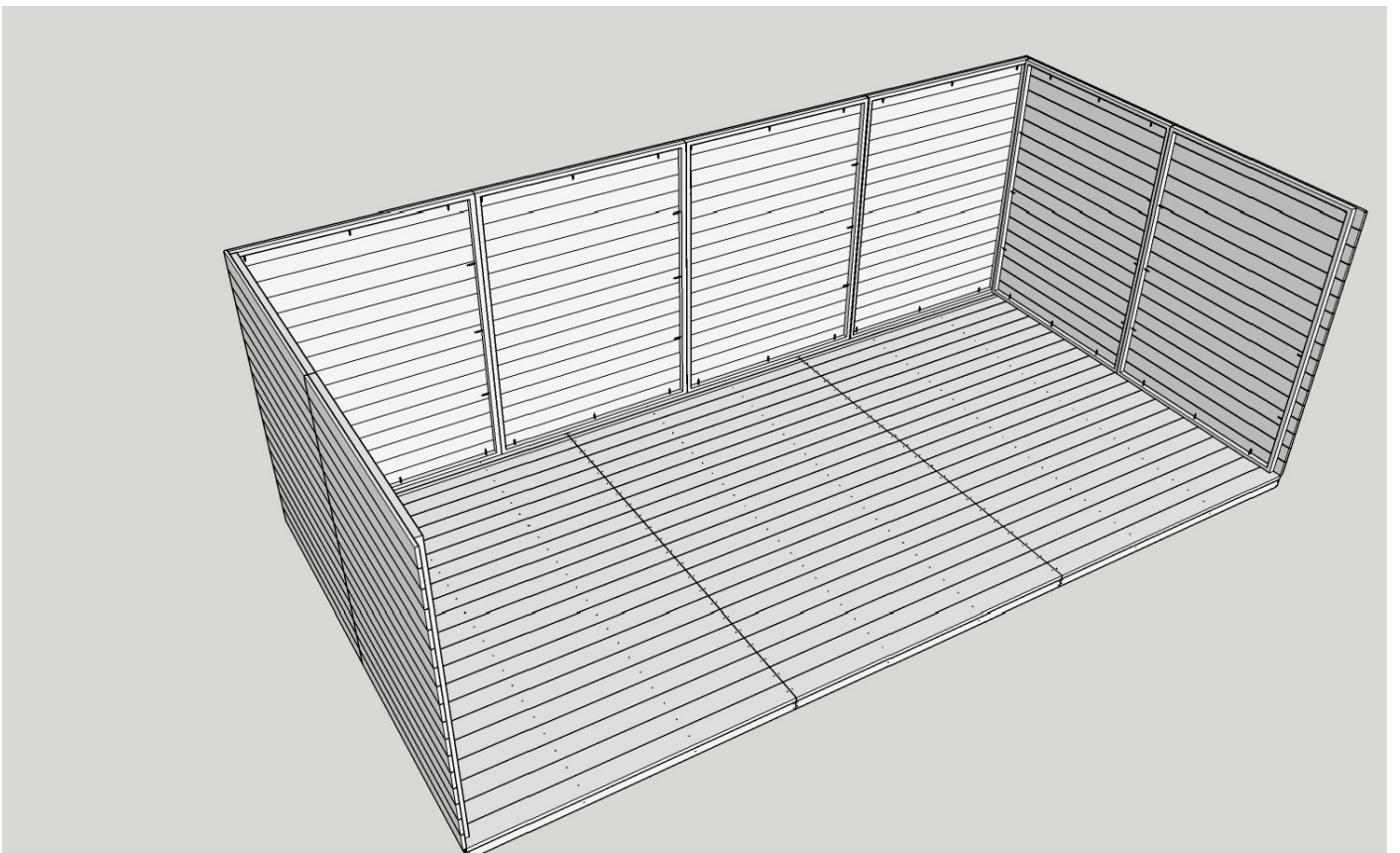
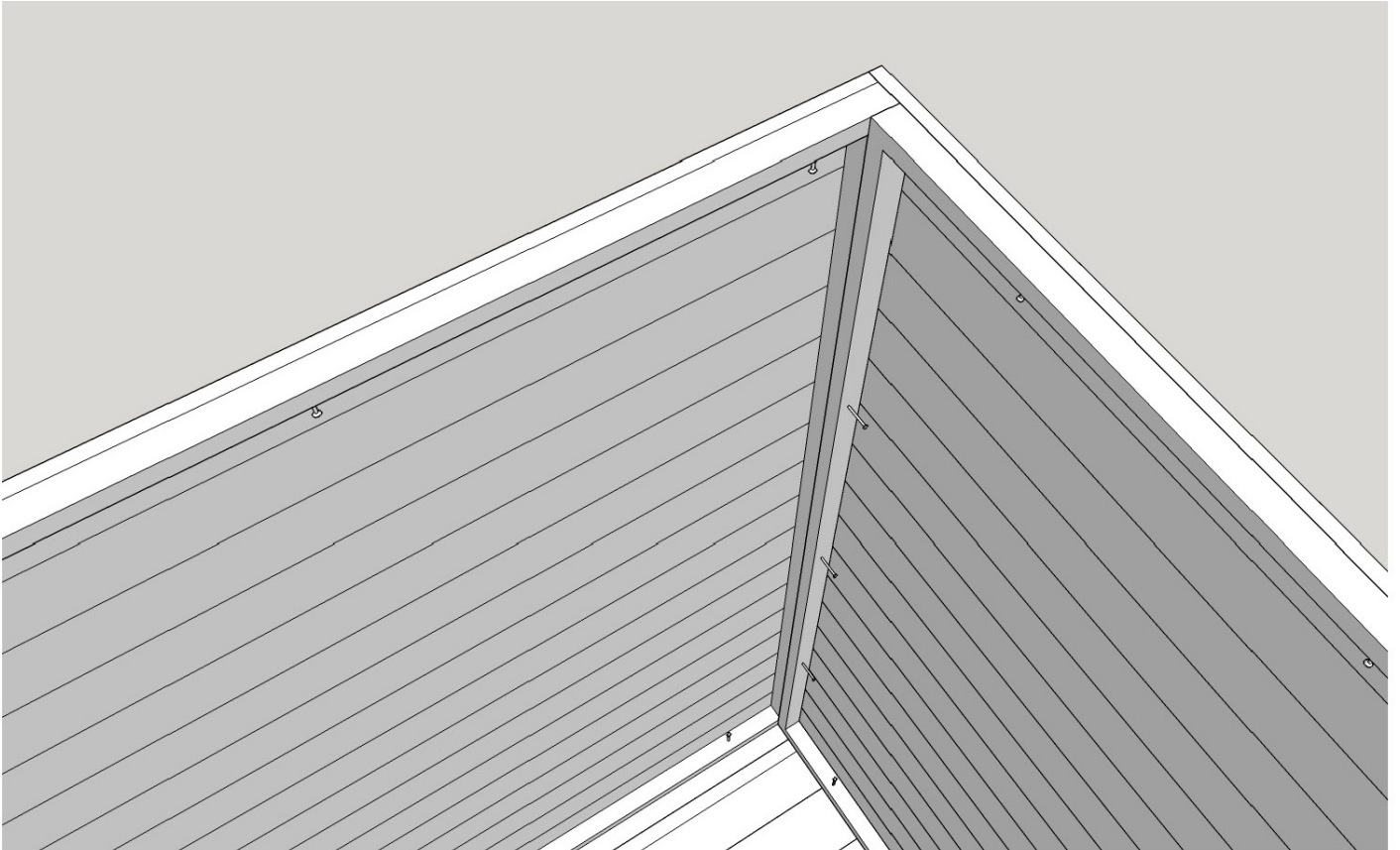

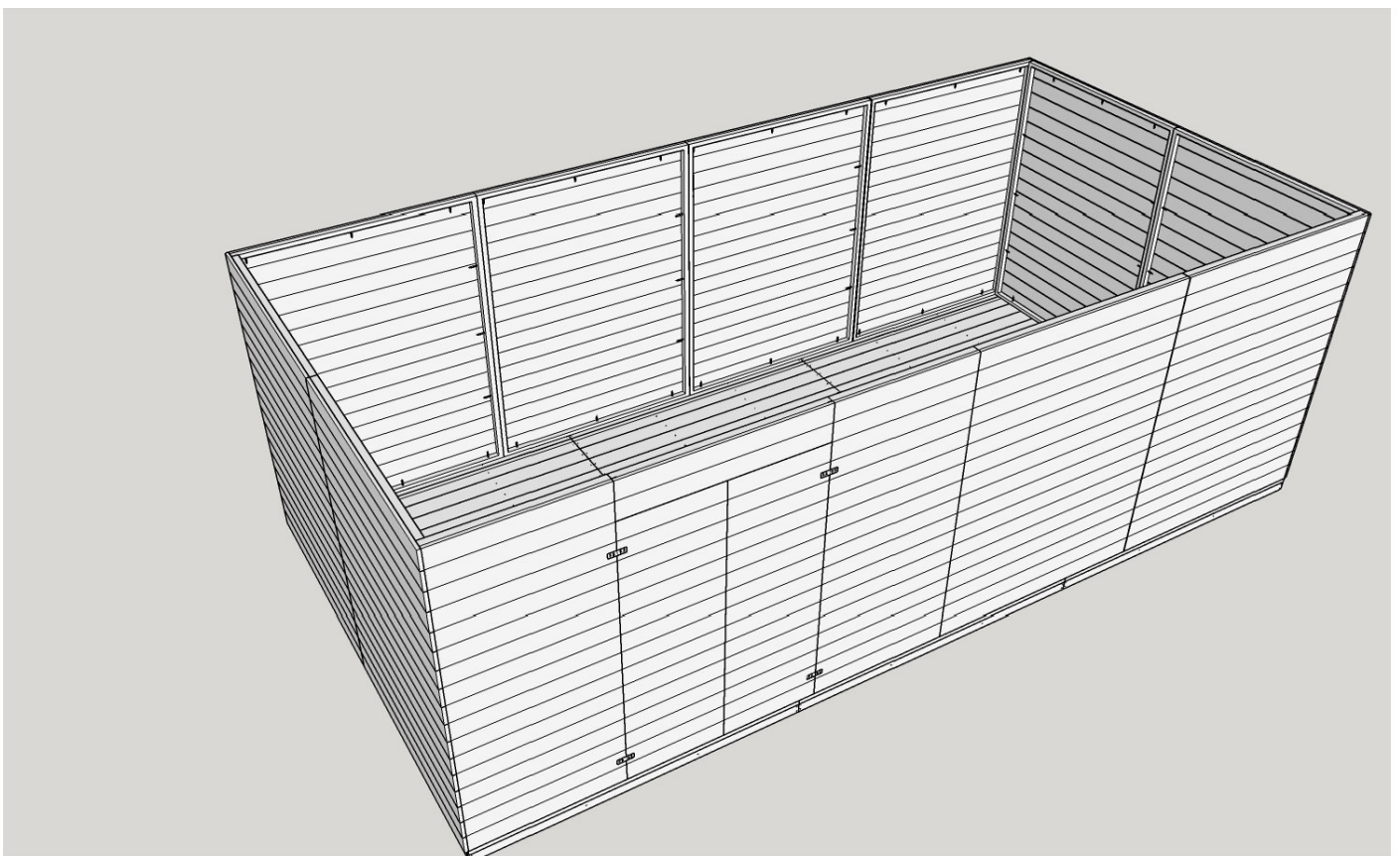
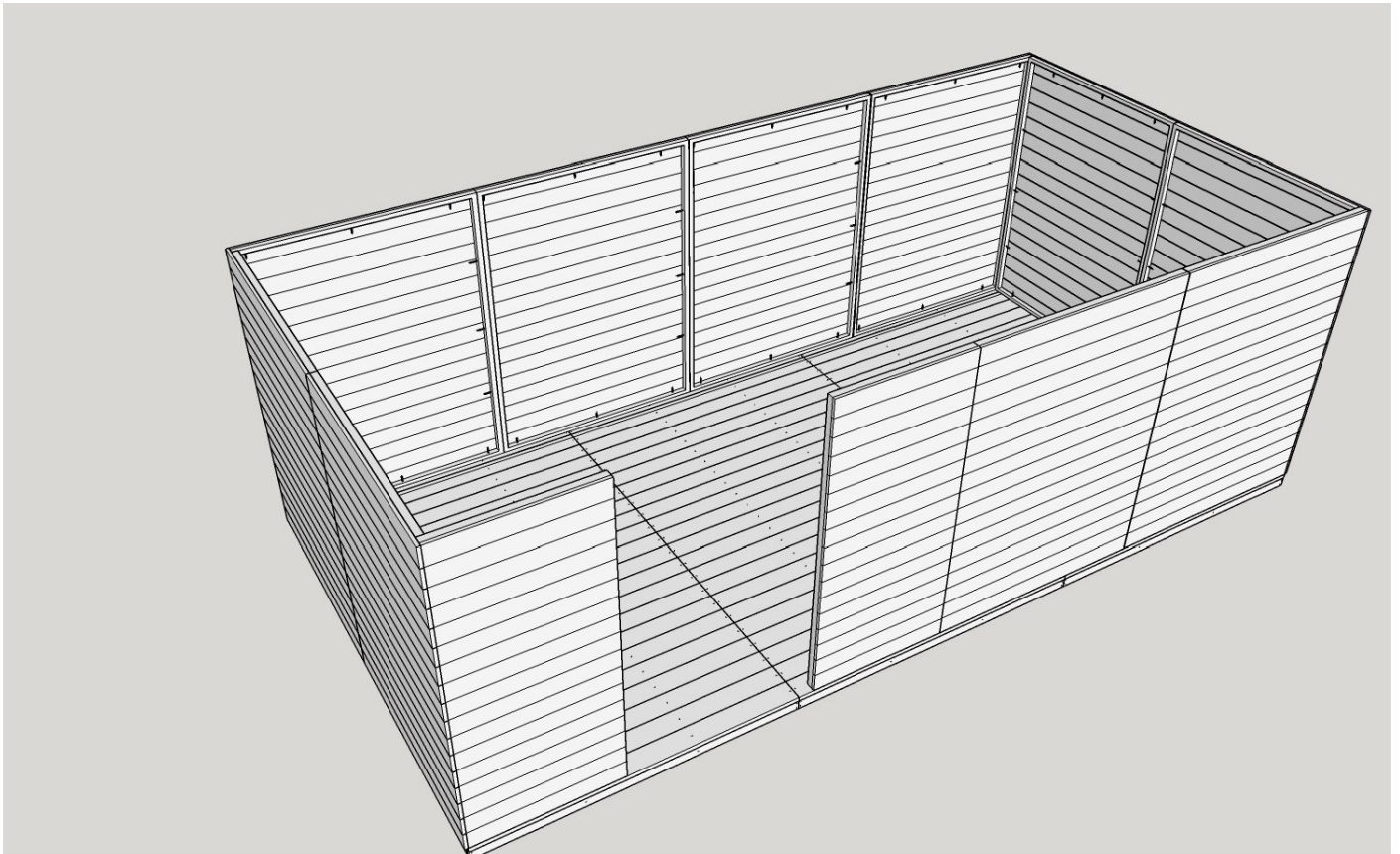

Uložení konstrukce střechy

Boční trojúhelník

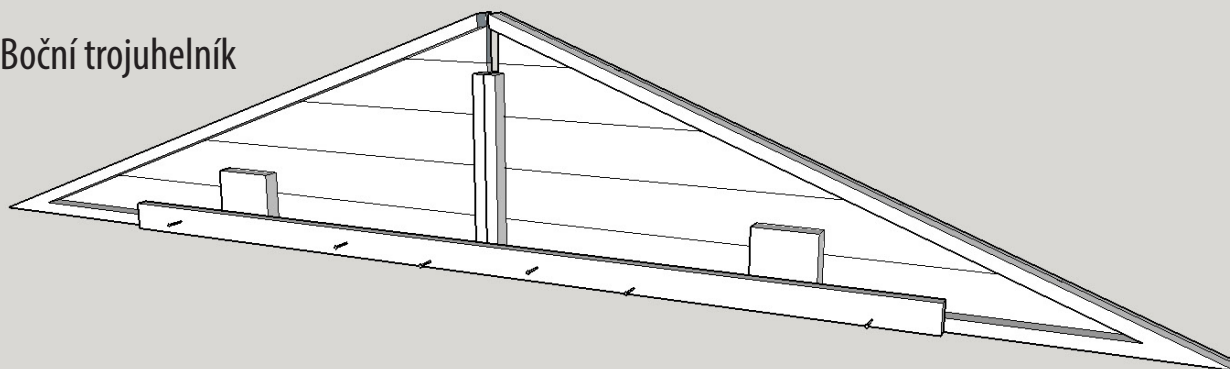

Vnitřní trojúhelník

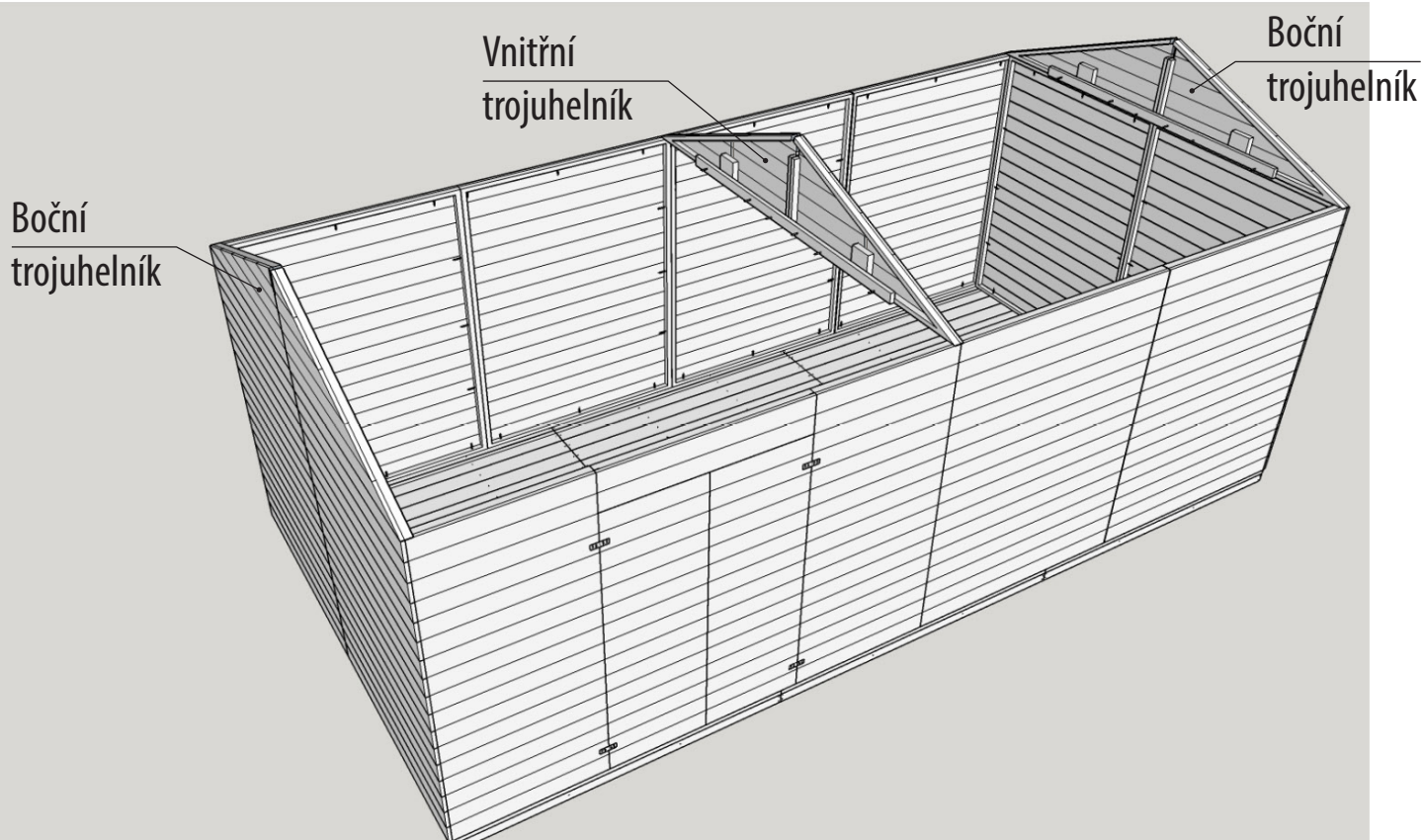
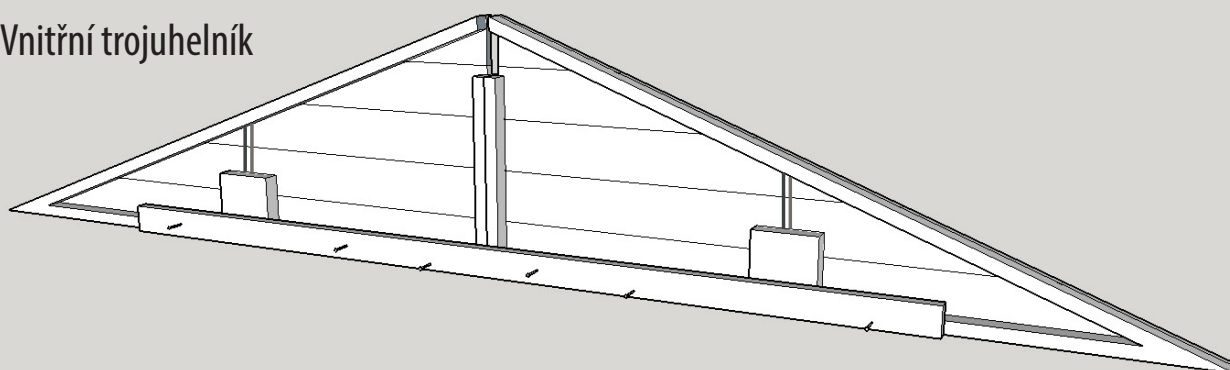

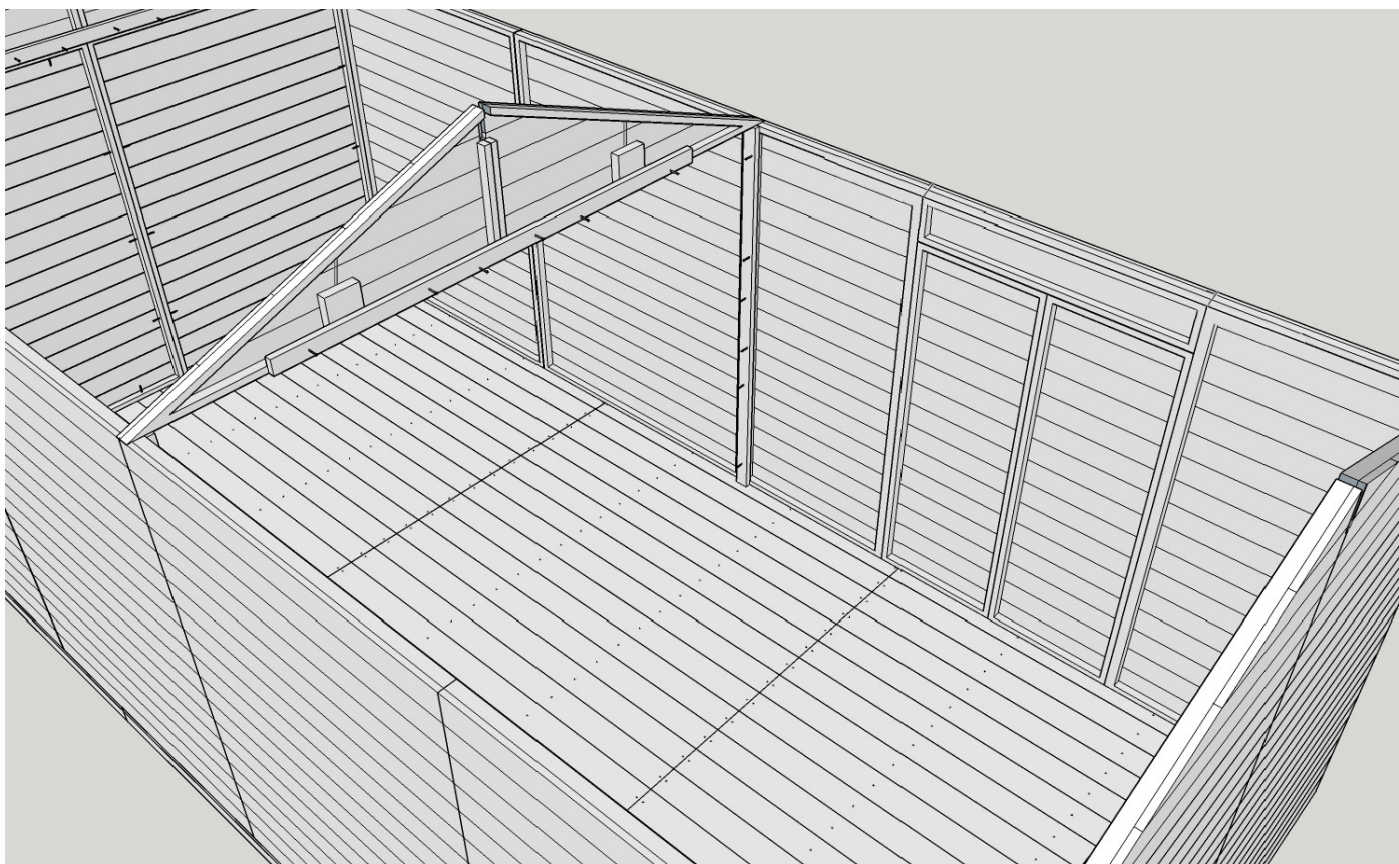
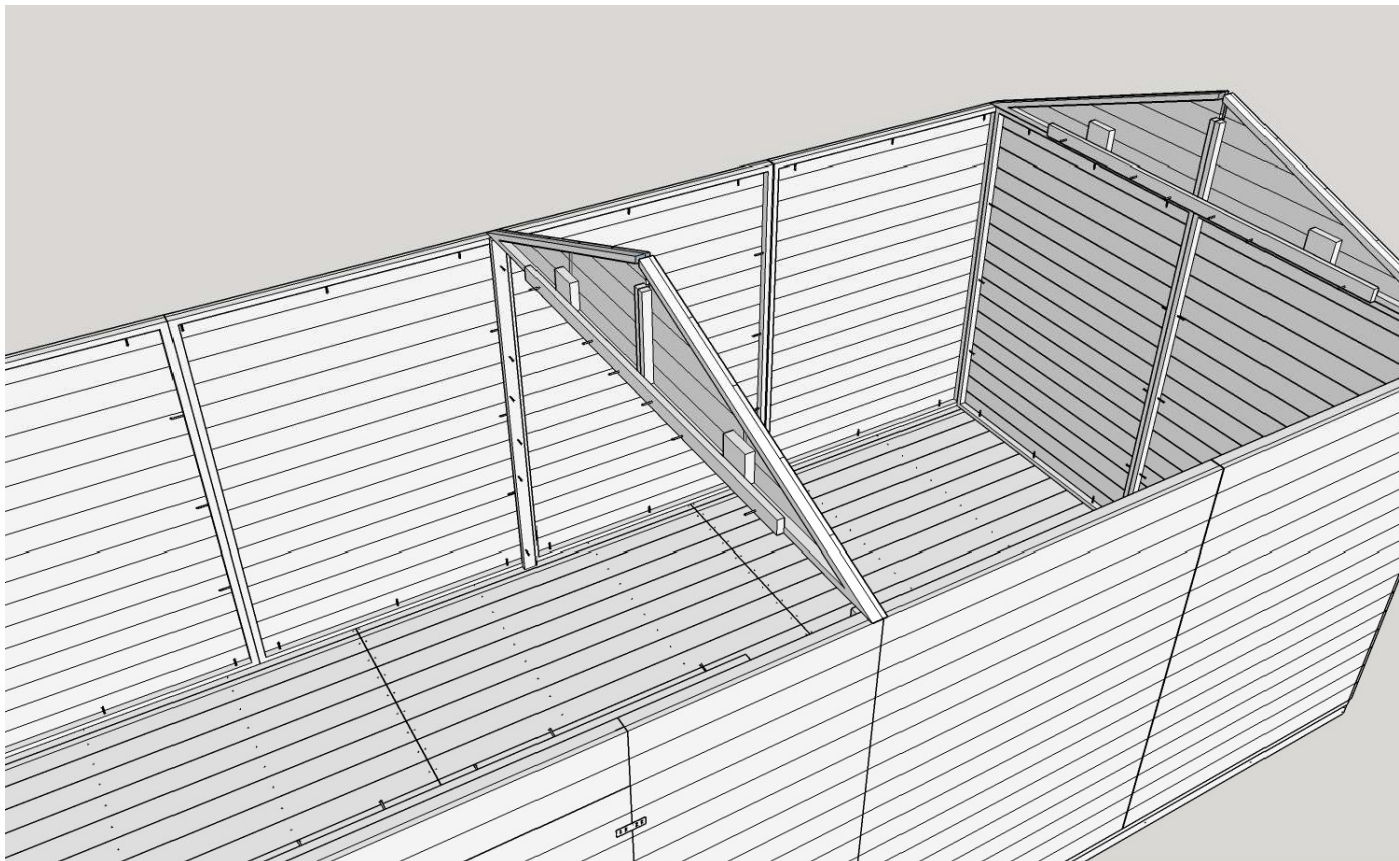

Středová krokev

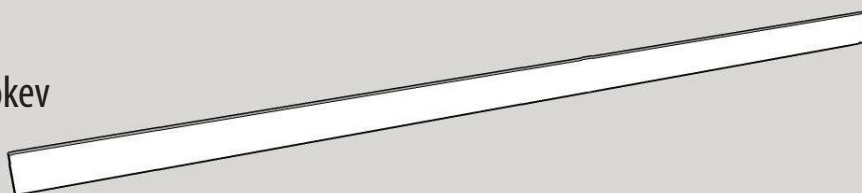

Boční krokev

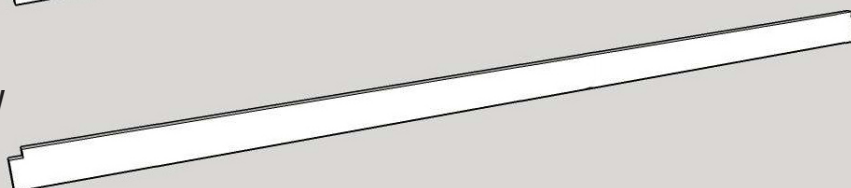

Nastavované krokvy

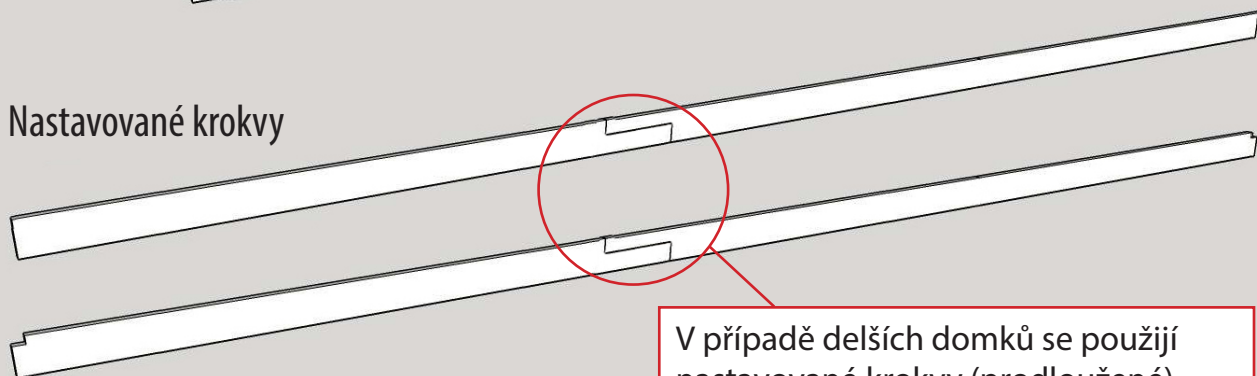

V případě delších domků se použijí nastavované krokvy (prodloužené).

Boční krokev

Středová krokev

Boční krokev

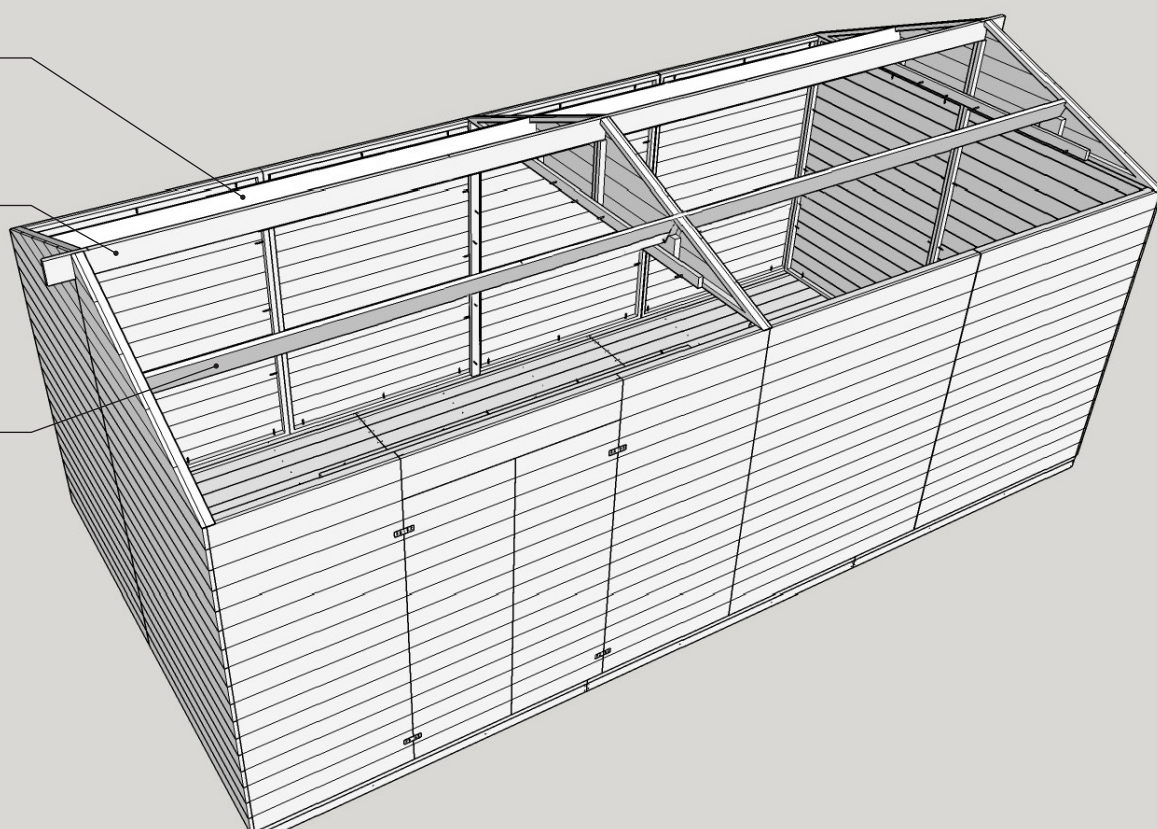

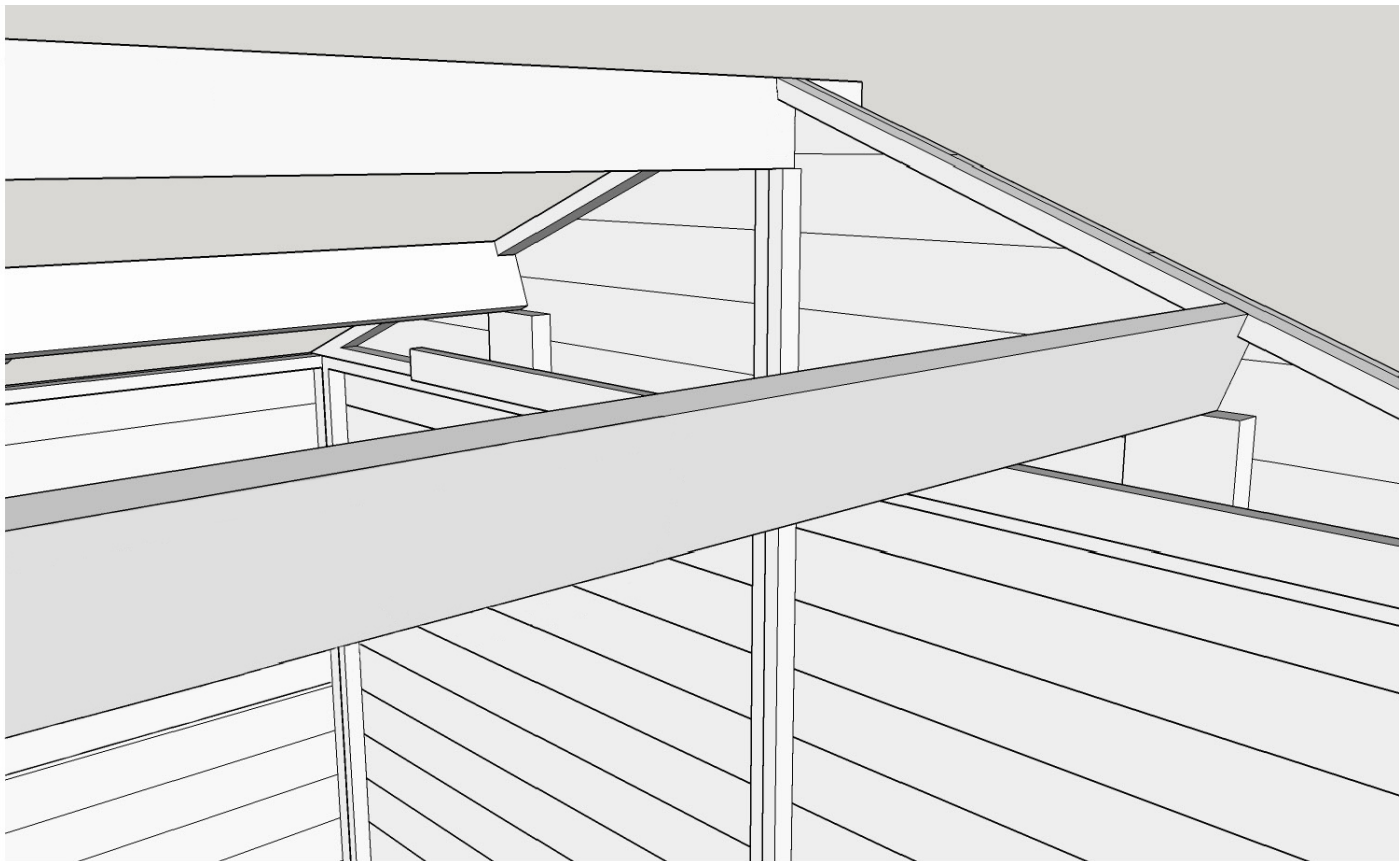

Uložení pokrytí střechy

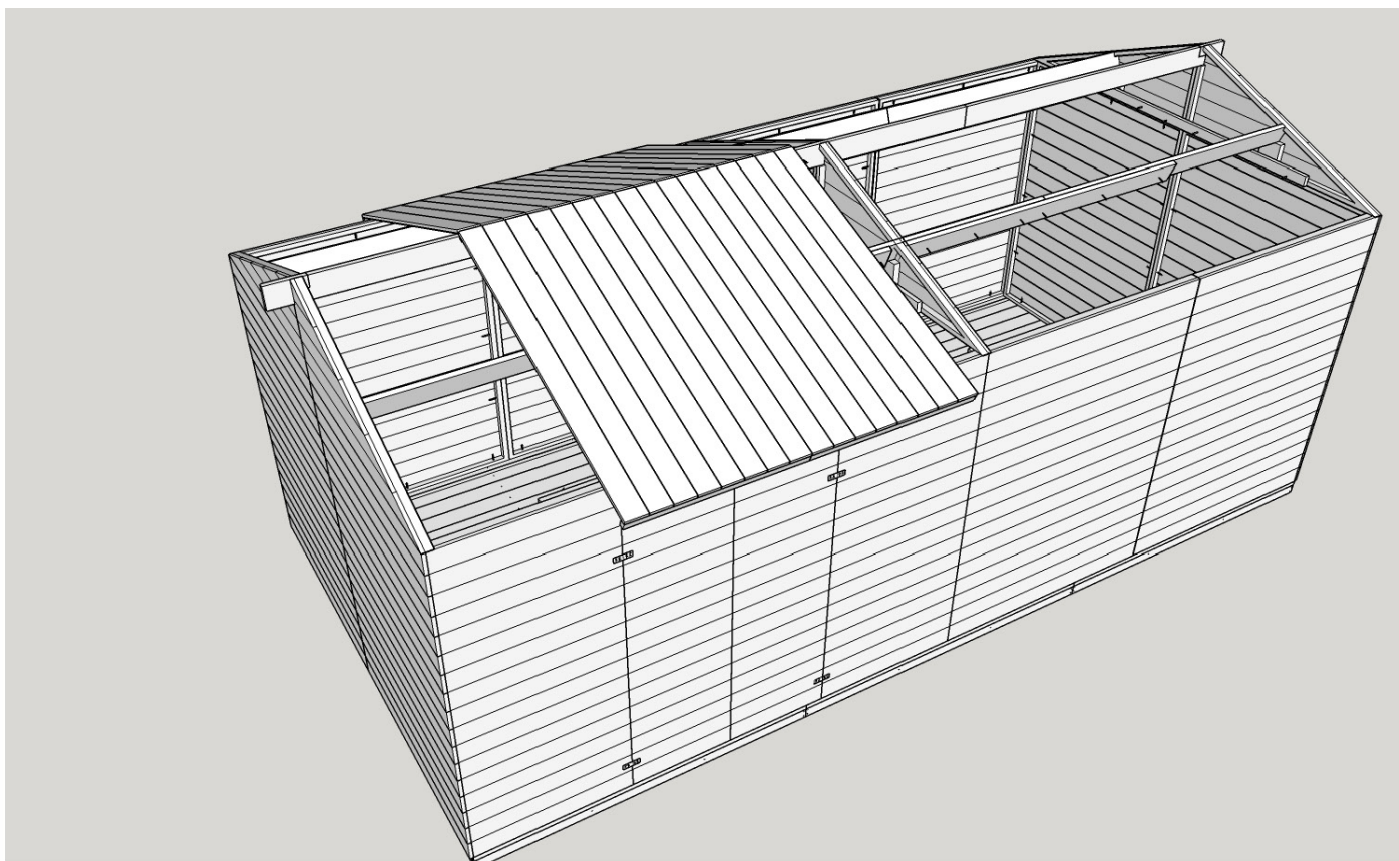

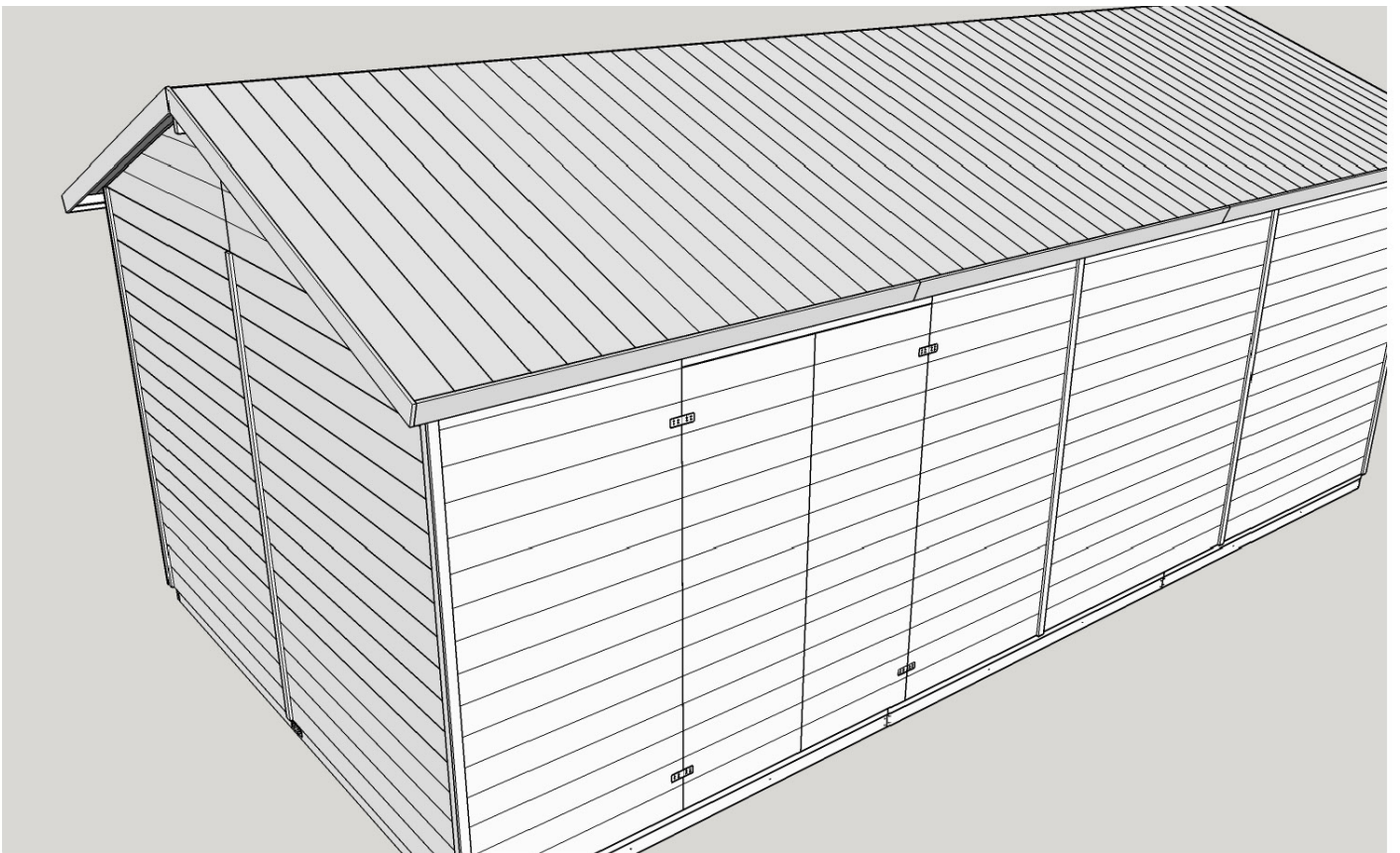
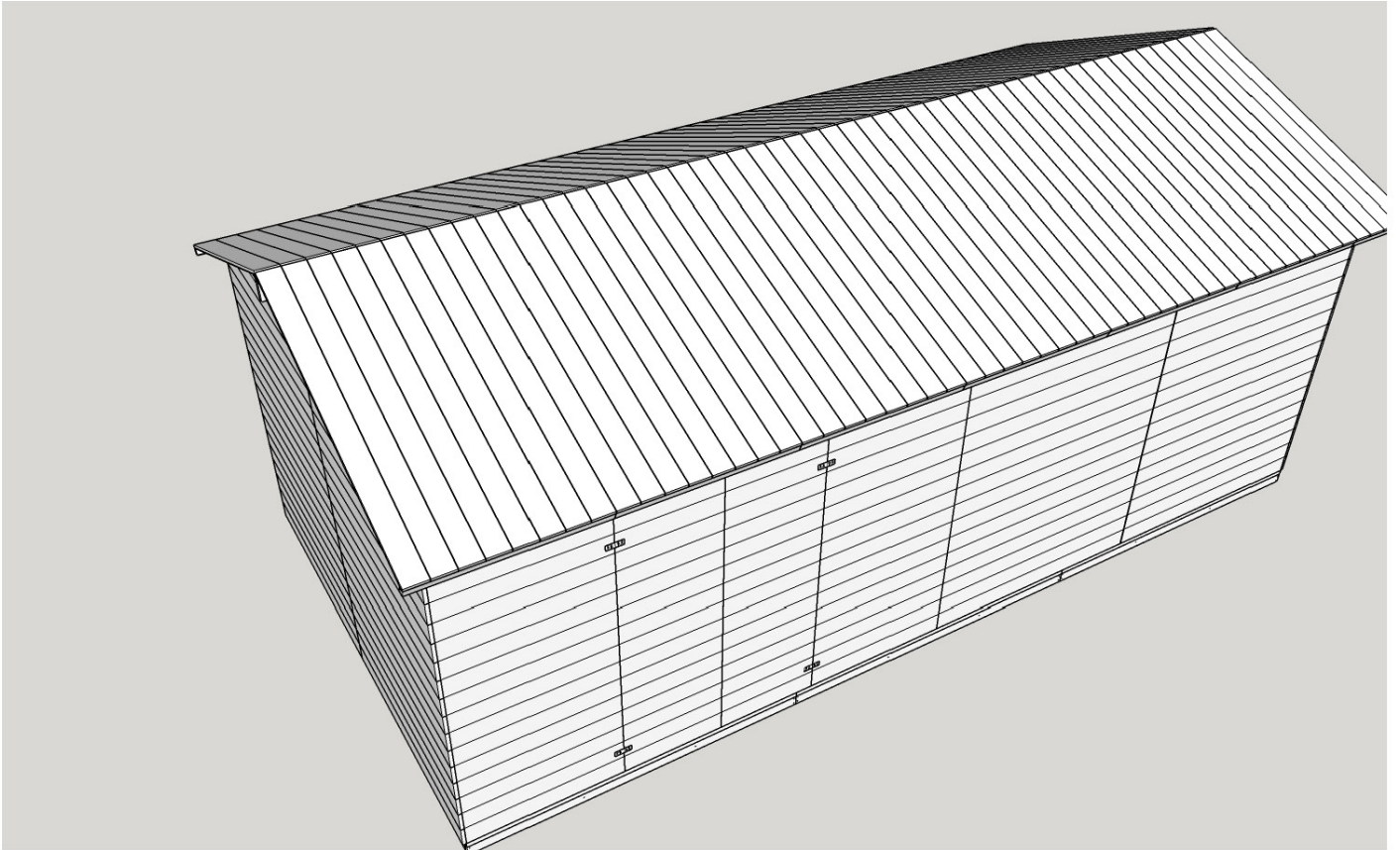

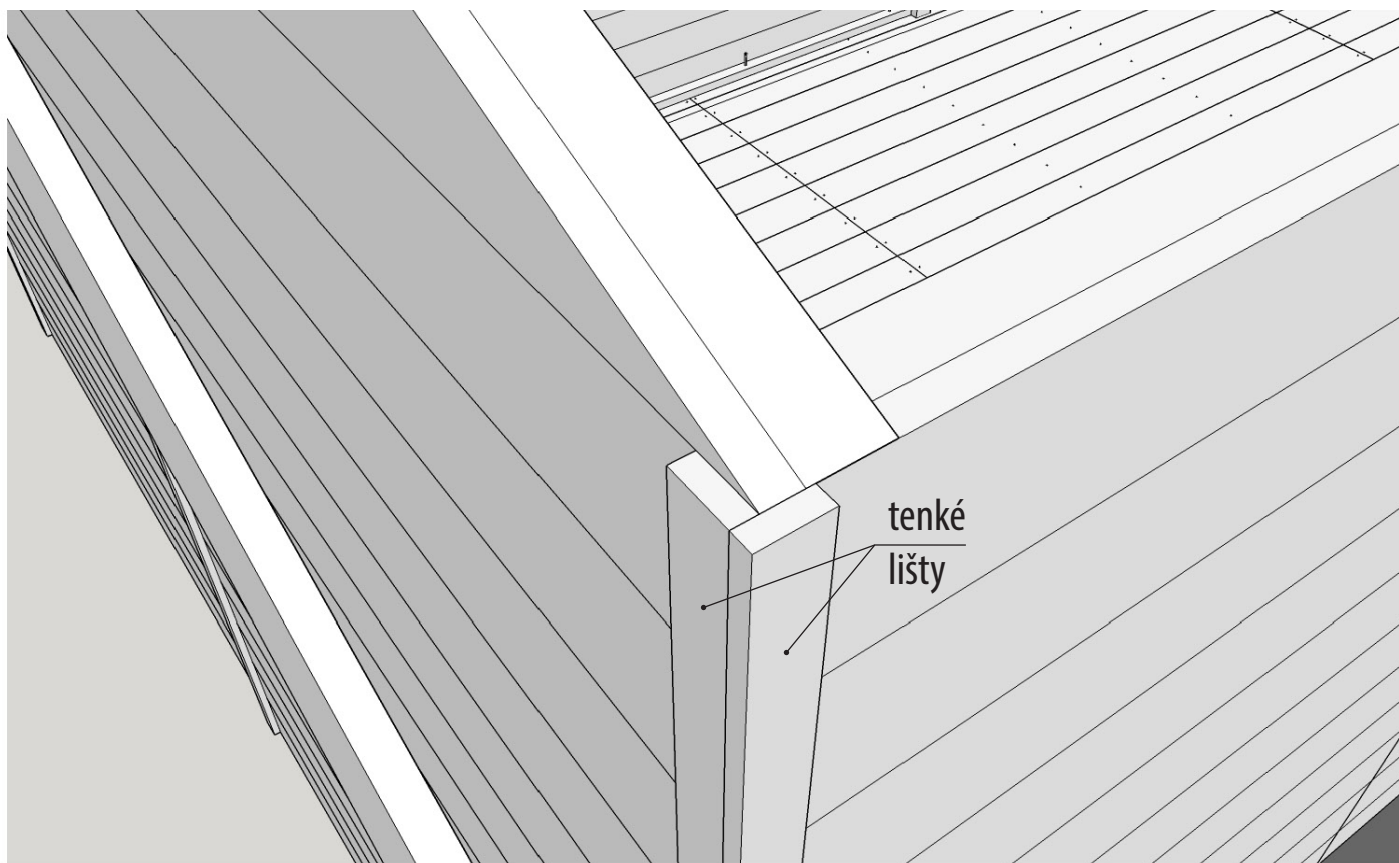

Postup při kladení asfaltové izolace

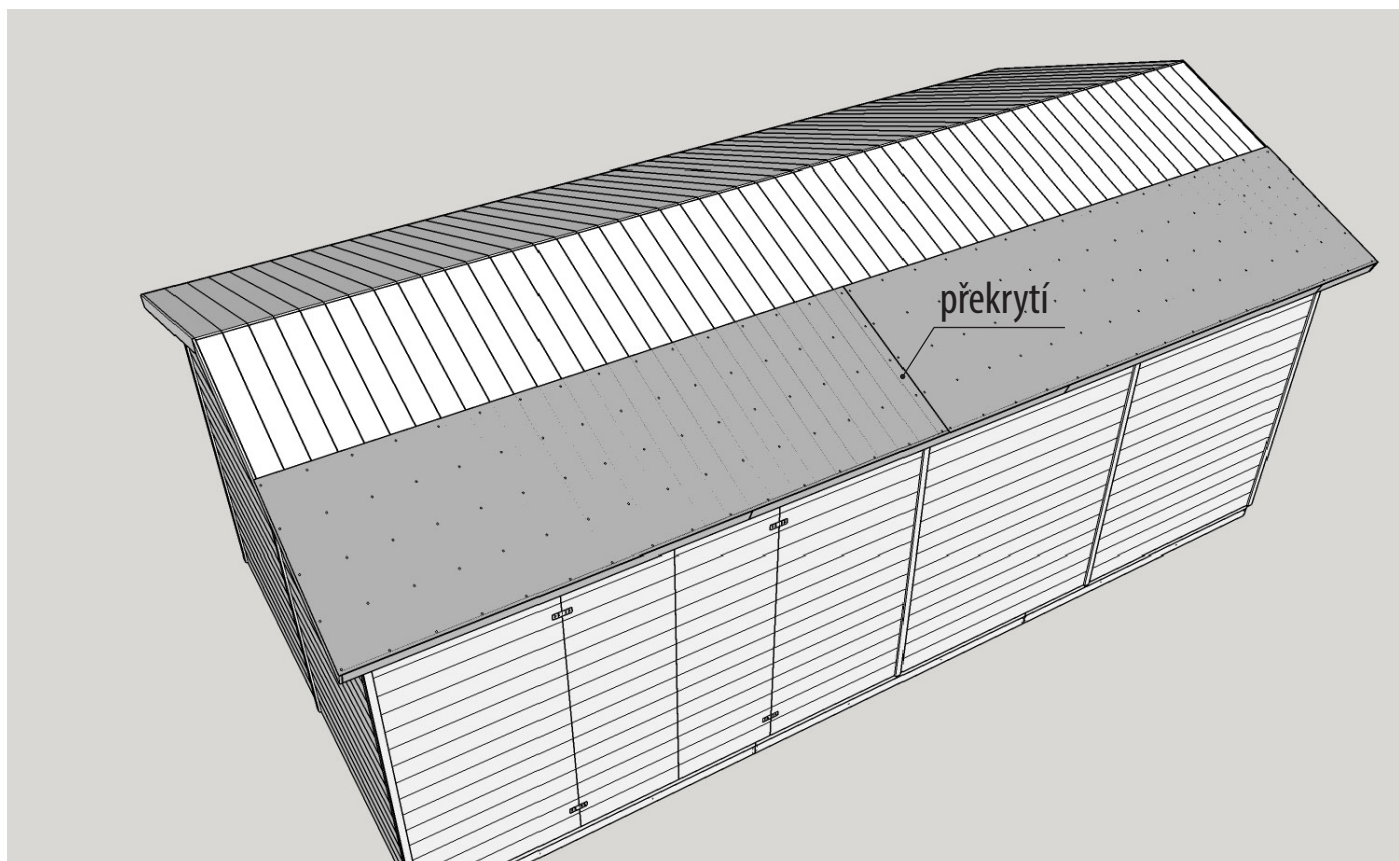

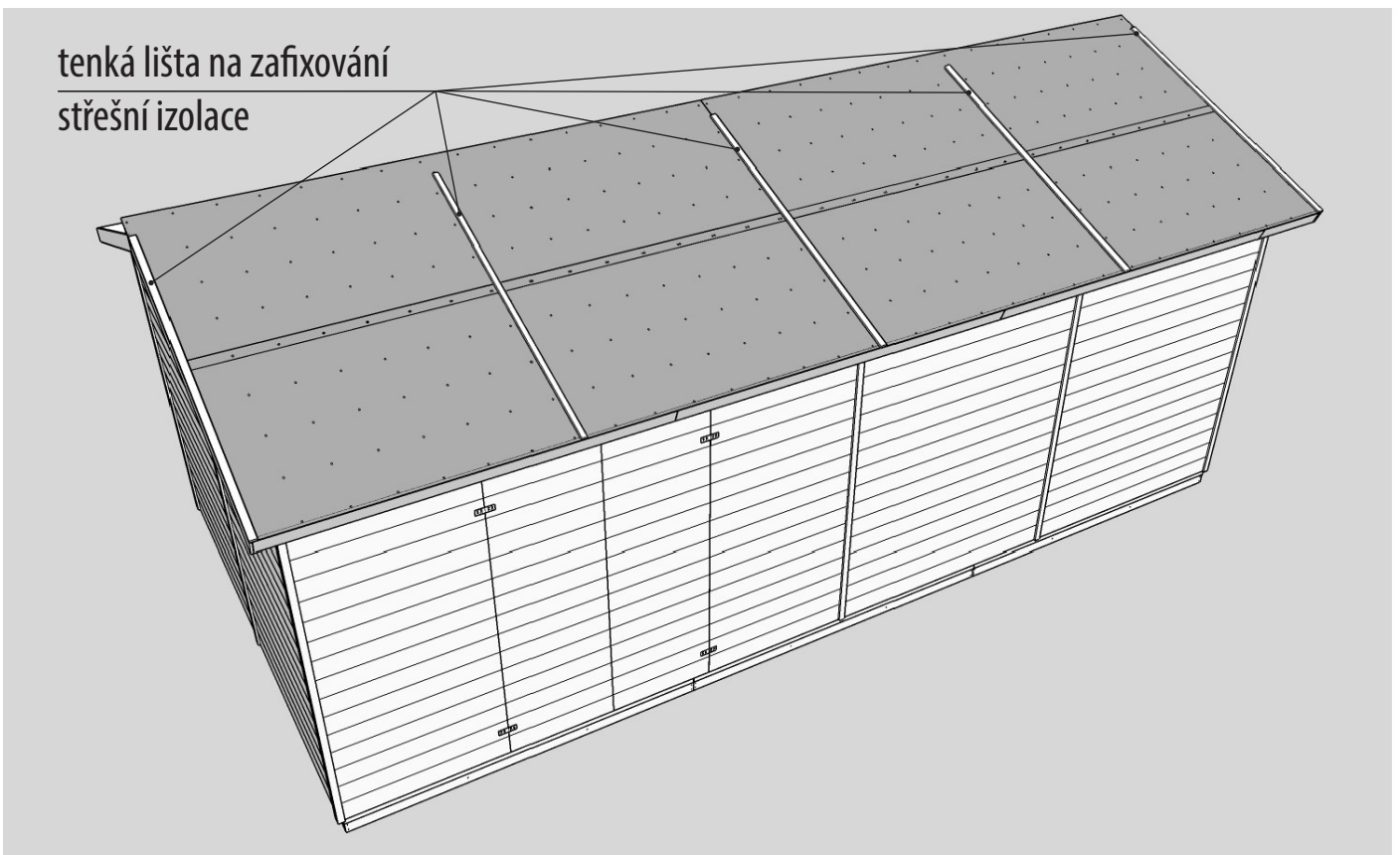
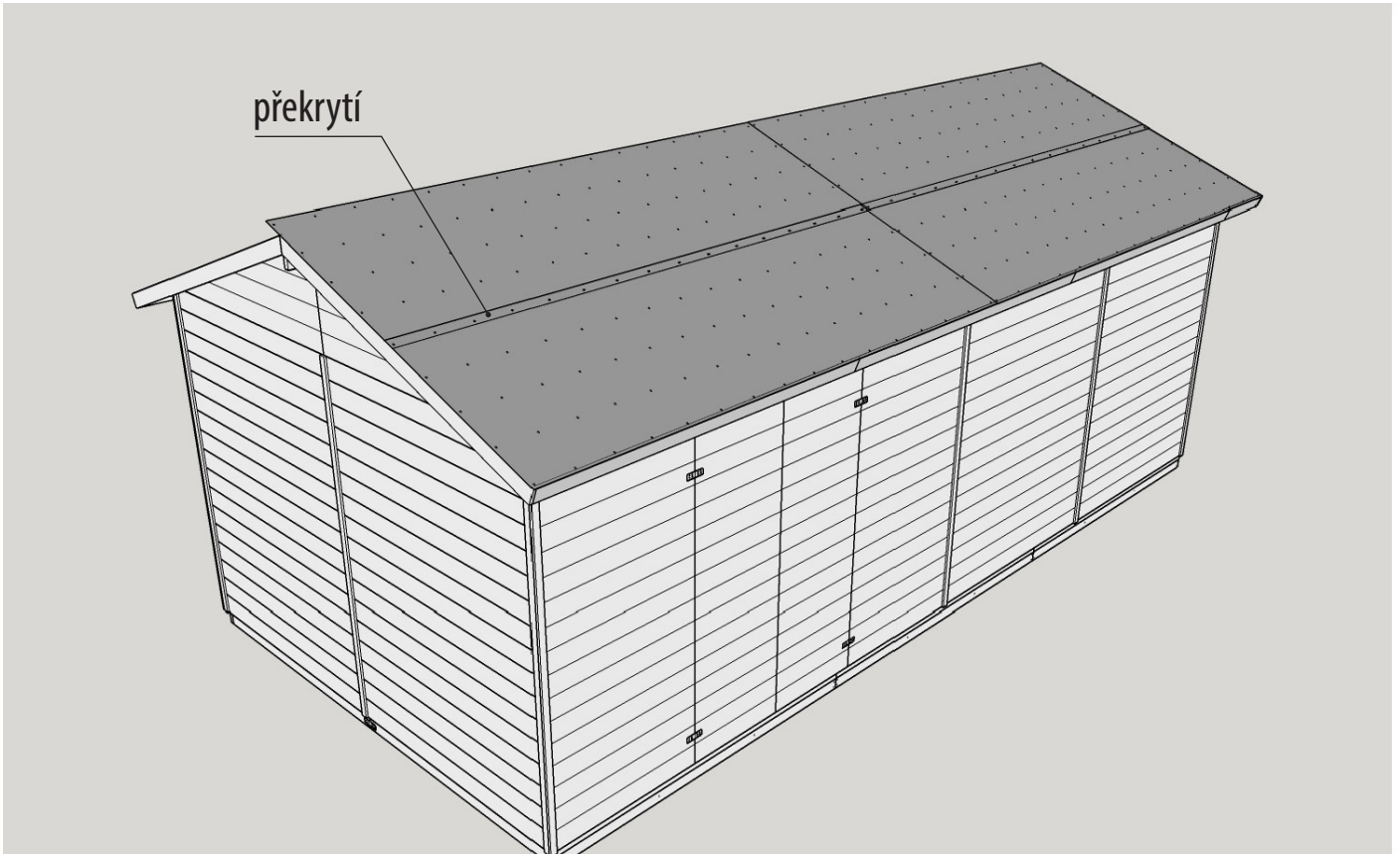

Děkujeme za výběr
zahradního domku z naší společnosti
a přejeme spokojené užívání.

Zahradní domky
MICHAL ZELMAN

www.nezahradnidomek.cz